

FREQUENCY

MODELS

ESTIMATED TIME TO COMPLETE

Daily – Monthly — Quarterly

Waterless Urinals - Smarti Environmental Products

2 mins per clean / per urinal



Health and Safety

Slippery Floors



Chemicals



Food Safety

Wash and dry hands every time after performing task

Equipment required for cleaning team and quarterly valve change



CLEANING GLOVES



SMARTI ENVIRONMENTAL PRODUCTS RECOMMENDED CLEANER



CLEANING CLOTH



CLEANING BUCKET (10 LTR)

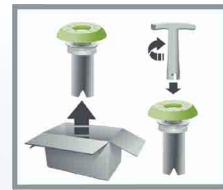

REPLACEMENT VALVE & KEY (SMARTI ENVIRONMENTAL PRODUCTS)

Daily:

Never use water or harsh bleach cleaners to flush urinal with the valve in place.

Failure to follow these tasks may cause damage to the Key-Valve™

DO NOT USE BLEACH

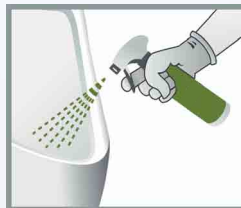

Spray urinal with Steri Kleen Bacterial recommended cleaner as part of the daily routine

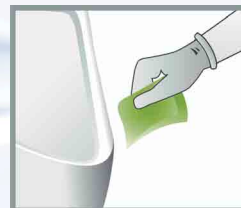

Remove dirt and particles using a dedicated urinal cloth

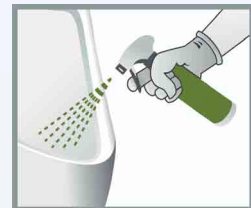

At the end of the cleaning routine, spray total inner part of the urinal and lower pipe work with Bacterial recommended cleaner.

ALWAYS LEAVE THE FLOOR CLEAN AND DRY.

DO NOT WIPE OFF AFTERWARDS

Monthly: Follow steps 1 and 2 of the Quarterly Cleaning routine below. **DO NOT USE BLEACH!** Re-install the valve with the service key.

Quarterly Cleaning*: Always refer to manufacturers/suppliers instructions. **DO NOT USE BLEACH!**



STEP 1
Remove old valve with service key



STEP 2
Flush with a 10 ltr bucket of water containing recommended Bacterial cleaner & fizzy drain tablet



STEP 3
Rinse and recycle Key Valve



STEP 4
Insert new Key Valve and activate with 1 litre of clean water as per instructions.

ALWAYS LEAVE THE FLOOR CLEAN AND DRY.

Note: If you are a Pay As You Save customer a Smarti team member will contact you to schedule ALL of your quarterly service and maintenance cleans and supply all new Key Valves.

WWW.SMARTIWATERFREE.COM

Corporate Social Responsibility
Supporting Water Charities Worldwide

CONTACT: 01392 311202